

# GT 4F舞台層

## 迴路總數:

3kw Multi :78CH  
 3kw 16A :126CH  
 3kw Switch:64CH  
 5kw 32A :16CH

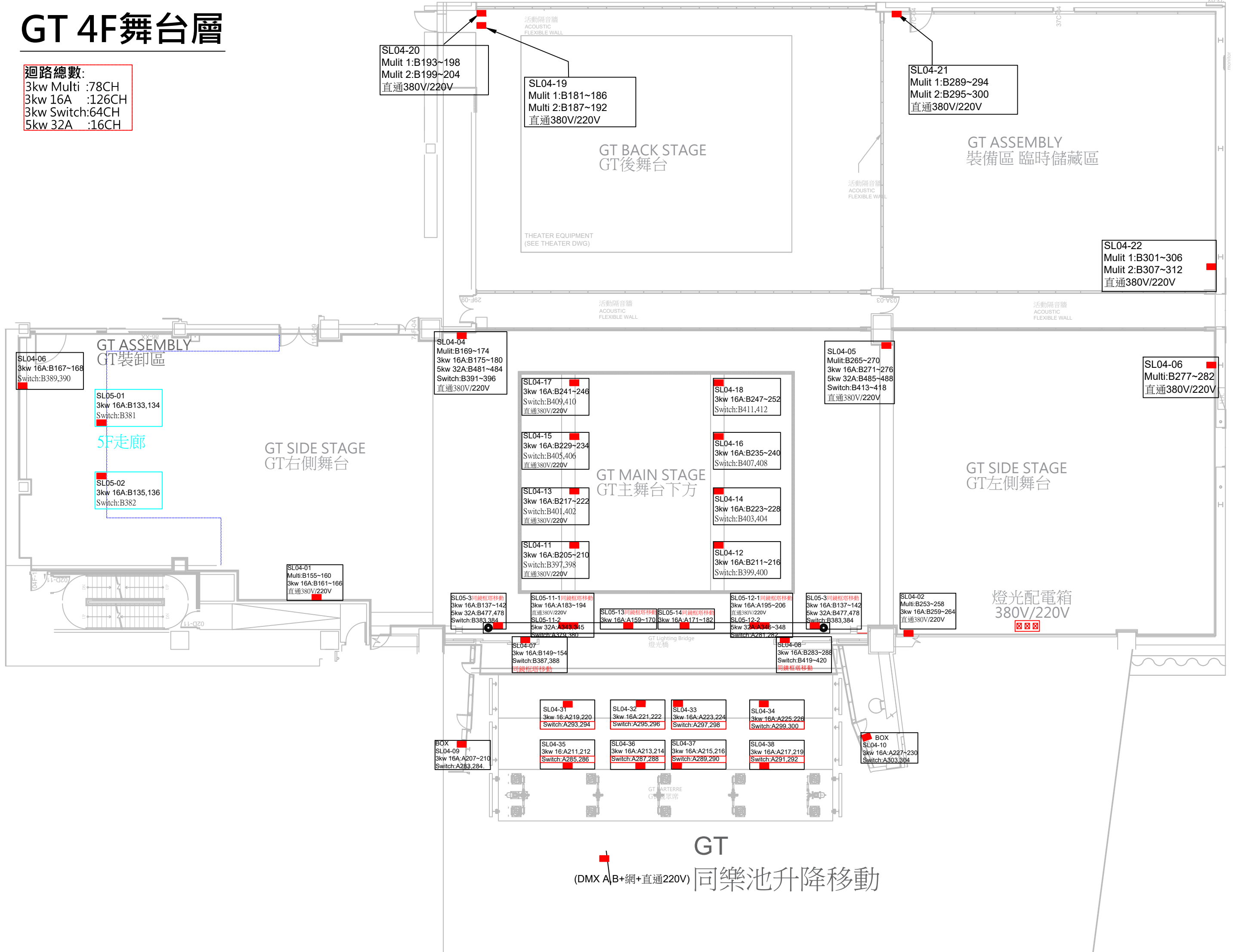

### SR BOX

迴路總數:  
 3kw 16A :16CH  
 3kw Switch:8CH  
 5kw 32A:8CH

### 7樓貓道

迴路總數:  
 3kw Multi:24CH  
 3kw 16A :90CH  
 3kw Switch:26CH  
 5kw 32A:18CH

### SL BOX

迴路總數:  
 3kw 16A :16CH  
 3kw Switch:8CH  
 5kw 32A:8CH

5F SR BOX	
SL05-15	Dim:A151~152 Dim5Kw:A339 Switch3Kw:A275
SL05-17	Dim:A153~154 Dim5Kw:A340 Switch3Kw:A276
SL05-21	Dim:A135~138 Dim5Kw:A331~332 Switch3Kw:A267~268
SL05-23	Dim:A139~142 Dim5Kw:A333~334 Switch3Kw:A269~270
6F SR BOX	
SL06-11	Dim:A127~128 Dim5Kw:A327 Switch3Kw:A263
SL06-13	Dim:A129~130 Dim5Kw:A328 Switch3Kw:A264
網路ENET 直通220V	

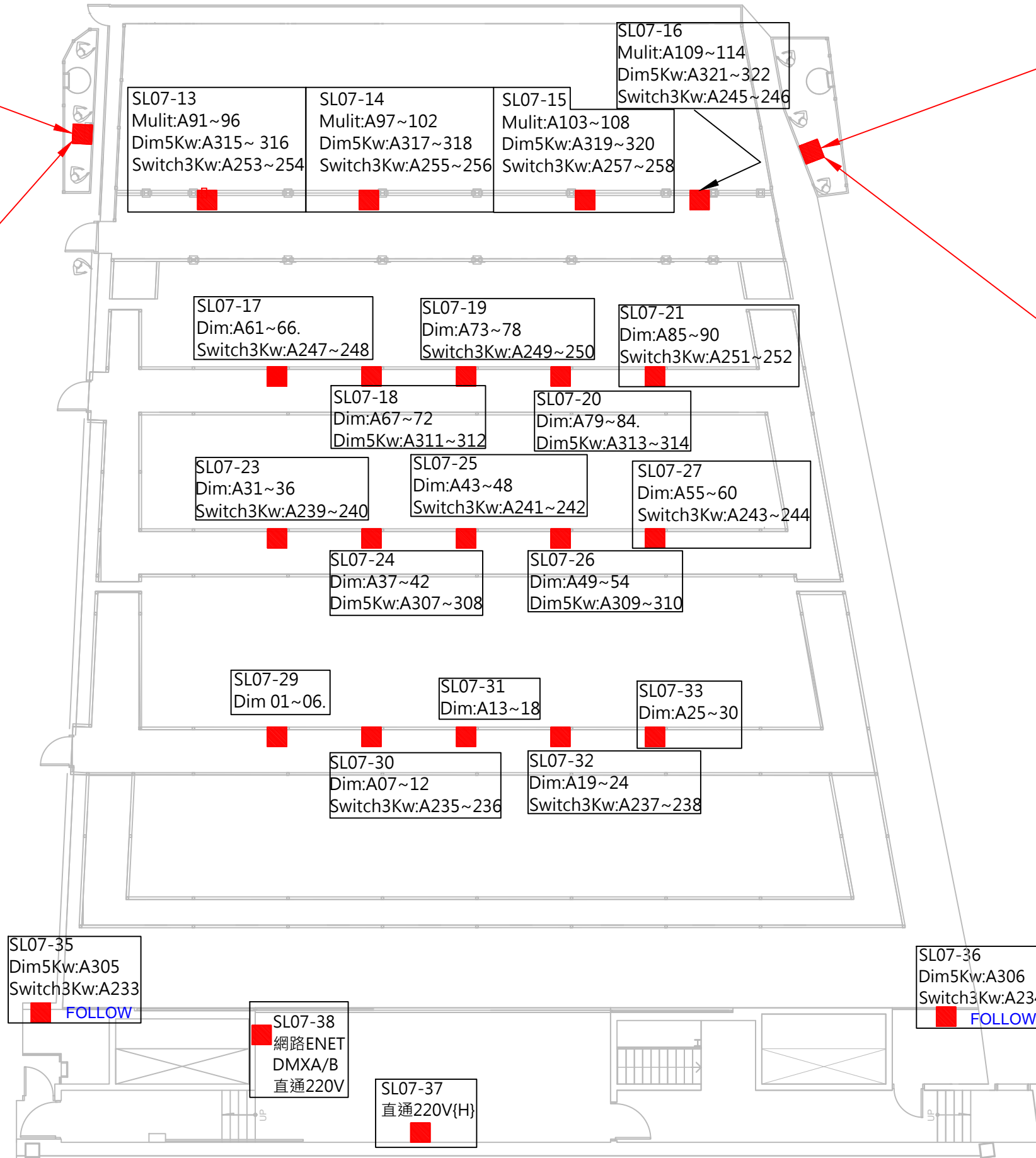

5F SL BOX	
SL05-16	Dim:A155~156 Dim5Kw:A341 Switch3Kw:A277
SL05-18	Dim:A157~158 Dim5Kw:A342 Switch3Kw:A278.
SL05-22	Dim:A143~146 Dim5Kw:A335~336 Switch3Kw:A271~272
SL05-24	Dim:A147~150 Dim5Kw:A337~338 Switch3Kw:A273~274
6F SL BOX	
SL06-12	Dim:A131~132 Dim5KW:A329 Switch3Kw:A265
SL06-14	Dim:A133~134 Dim5KW:A330 Switch3Kw:A266
網路ENET. 直通 220V	

SL06-25  
Dim:B065~068  
Dim5Kw:B461~462  
Switch3Kw:B367

SL06-26  
Dim:B129~132  
Dim5Kw:B475~476  
Switch3Kw:B380

### 6樓後舞台廊道

迴路總數:  
3kw 16A :24CH  
3kw Switch:6CH  
5kw 32A :12CH

SL06-23  
Dim:B061~064  
Dim5Kw:B459~460  
Switch3Kw:B366

SL06-24  
Dim:B125~128  
Dim5Kw:B473~474  
Switch3Kw:B379

SL06-21  
Dim:B057~060  
Dim5Kw:B457~458  
Switch3Kw:B365

SL06-22  
Dim:B121~124  
Dim5Kw:B471~472  
Switch3Kw:B378

SL06-7  
Mulit:B051~056  
Dim:B045~050  
Dim5Kw:B455~456  
Switch3Kw:B363~364

### GT 6樓廊道

迴路總數:  
3kw Multi :48CH  
3kw 16A :60CH  
3kw Switch:20CH  
5kw 32A :16CH

SL06-8  
Mulit:B115~120  
Dim:B109~114  
Dim5Kw:B469~470  
Switch3Kw:B376~377

SL06-5  
Mulit:B039~044  
Dim:B033~038  
Dim5Kw:B453~454  
Switch3Kw:B361~362

SL06-6  
Mulit:B103~108  
Dim:B097~102  
Dim5Kw:B467~468  
Switch3Kw:B374~375

SL06-3  
Mulit:B027~032  
Dim3Kw:B021~026  
Dim5Kw:B451~452  
Switch3Kw:B359~360

SL06-4  
Mulit:B091~096  
Dim:B085~090  
Dim5Kw:B465~466  
Switch3Kw:B372~373

SL06-1  
Mulit B015~020  
Dim:B009~014  
Dim5Kw:B449~450  
Switch3Kw:B357~358

SL06-2  
Mulit:B079~084  
Dim:B073~078  
Dim5Kw:B463~464  
Switch3Kw:B370~371

SL06-9  
Dim:B005~008  
Switch3Kw:B355~356

SL06-10  
Dim:B069~072  
Switch3Kw:B368~369

SL07-1  
Mulit 115~120  
Dim:與MULTI同號  
Dim5Kw:A323~324  
Switch3Kw:A259~260

SL07-2  
Mulit:A121~126  
Dim:與MULTI同號  
Dim5Kw:A325~326  
Switch3Kw:A261~262

### GT 7樓後廊道

迴路總數:  
3kw Multi :12CH  
3kw 16A :12CH (Multi同號)  
3kw Switch:4CH  
5kw 32A :4CH

SL10-3  
Mulit:A349~372.  
5Kw 32A:B421~424  
5Kw **Harting:**  
Switch3Kw:B313~318

SL10-5  
Mulit:A397~420  
5Kw **Harting:**  
5Kw 32A:B429~432  
Switch3Kw:B325~330

SL10-7  
Mulit:A445~468.  
5Kw 32A:B437~440  
5Kw **Harting:**  
Switch3Kw:B337~342

SL10-9  
Mulit:A493~516  
5Kw 32A:B445~448  
5Kw **Harting:**  
Switch3Kw:B349~354

SL10-4  
Mulit:A373~396.  
5Kw 32A:B425~428  
5Kw **Harting:**  
Switch3Kw:B319~324

SL10-6  
Mulit:A421~444.  
5Kw 32A:B433~436  
5Kw **Harting:**  
Switch3Kw:B331~336

SL10-08  
Mulit:A469~492.  
5Kw 32A:B441~444  
5Kw**Harting:**  
Switch3Kw:B343~348

SL10-1  
DMX A,B  
網路 +直通 380/220V

## GT10樓頂棚

**迴路總數:**  
3kw Multi:170CH  
3kw Switch:42CH  
5kw Harting:28CH

SL10-2  
網路  
直通 380/220V